

## COPIGLIE

FE

DIN 94  
UNI 1336  
ISO 1234

DIAMETRO M 2 - M 10  
LUNGHEZZA 20 - 120

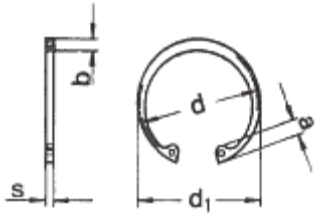

## SEEGER INTERNI

ACC.45/55

DIN 472  
UNI 7437  
ISO .

DIAMETRO M 8 - M 105  
LUNGHEZZA .

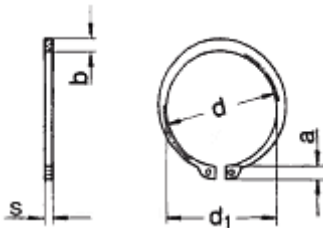

## SEEGER ESTERNI

ACC.45/55

DIN 471  
UNI 7435  
ISO .

DIAMETRO M 3 - M 100  
LUNGHEZZA .

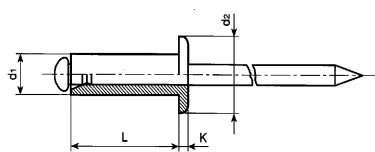

## RIVETTI A STRAPPO TIPO A

ACC. INOX

DIN .  
UNI .  
ISO .

DIAMETRO M 2,4 - M 6,4  
LUNGHEZZA 5 - 50

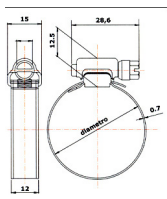

## FASCETTE STRINGITUBO

DIN .  
UNI .  
ISO .

DIAMETRO M 8 - M 80  
LUNGHEZZA 12 - 100

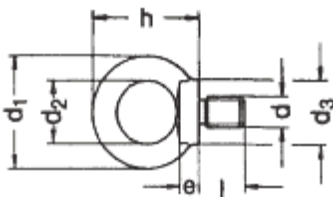

## GOLFARI MASCHI

FE

DIN 580  
UNI .  
ISO .

DIAMETRO M 6 - M 36  
LUNGHEZZA .

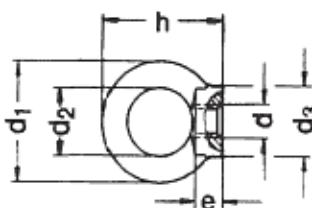

## GOLFARI FEMMINA

FE

DIN 582  
UNI .  
ISO .

DIAMETRO M 6 - M 36  
LUNGHEZZA .

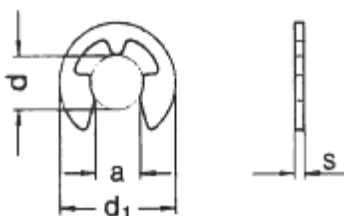

## BENZING

ACC. HRC 47-51

DIN 6799  
UNI 7434  
ISO .

DIAMETRO M 1,2 - M 19  
LUNGHEZZA .